

# STELLA Mechanism

## Installation Instructions

18678201 Rev B Page 1 of 1

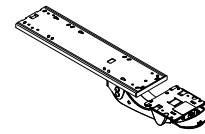

SS20

- 1** Please make use of all appropriate hardware provided. Retain two (2) screws for attachment of front cap. Mounting screws are 1" in length. When attaching track to a worksurface with a 1" thickness or less, please source appropriate length screws locally.

Pre-drilled holes.  
Attach track.

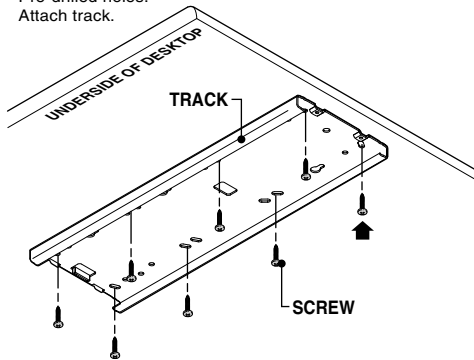

- 2** Slide mechanism into track.

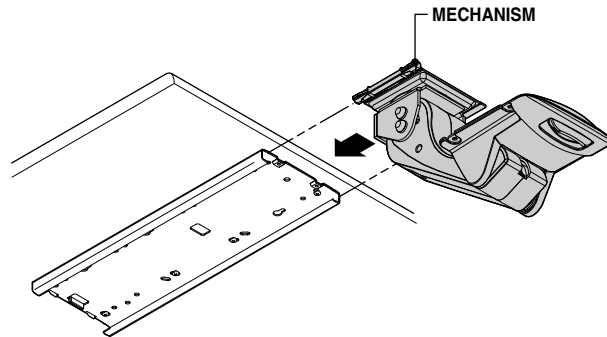

To Enable Positive Tilt:

- A** Remove tilt lock-out sleeve from tilt rod.

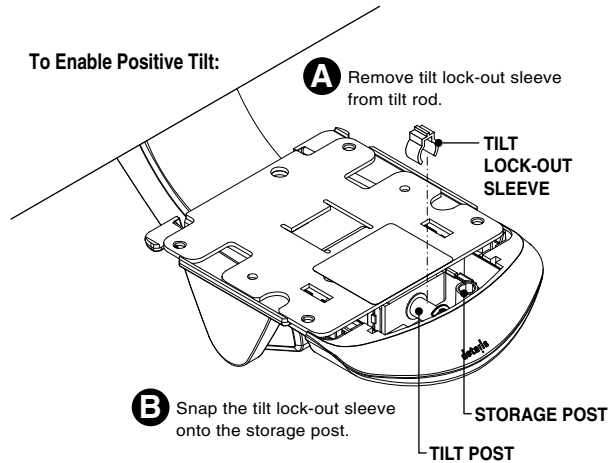

- B** Snap the tilt lock-out sleeve onto the storage post.

- 3** Insert end cap.

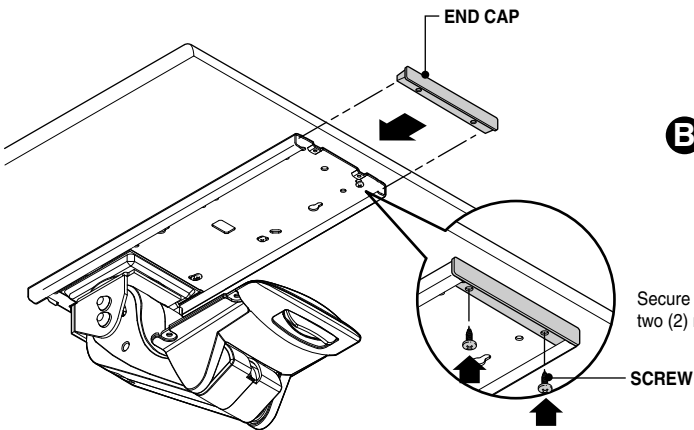

Secure front cap with the two (2) machine screws provided.

For a better day at work.™

**details**

A STEELCASE COMPANY